

DECK PLANS

# ABOARD STAR PRIDE, STAR BREEZE & STAR LEGEND

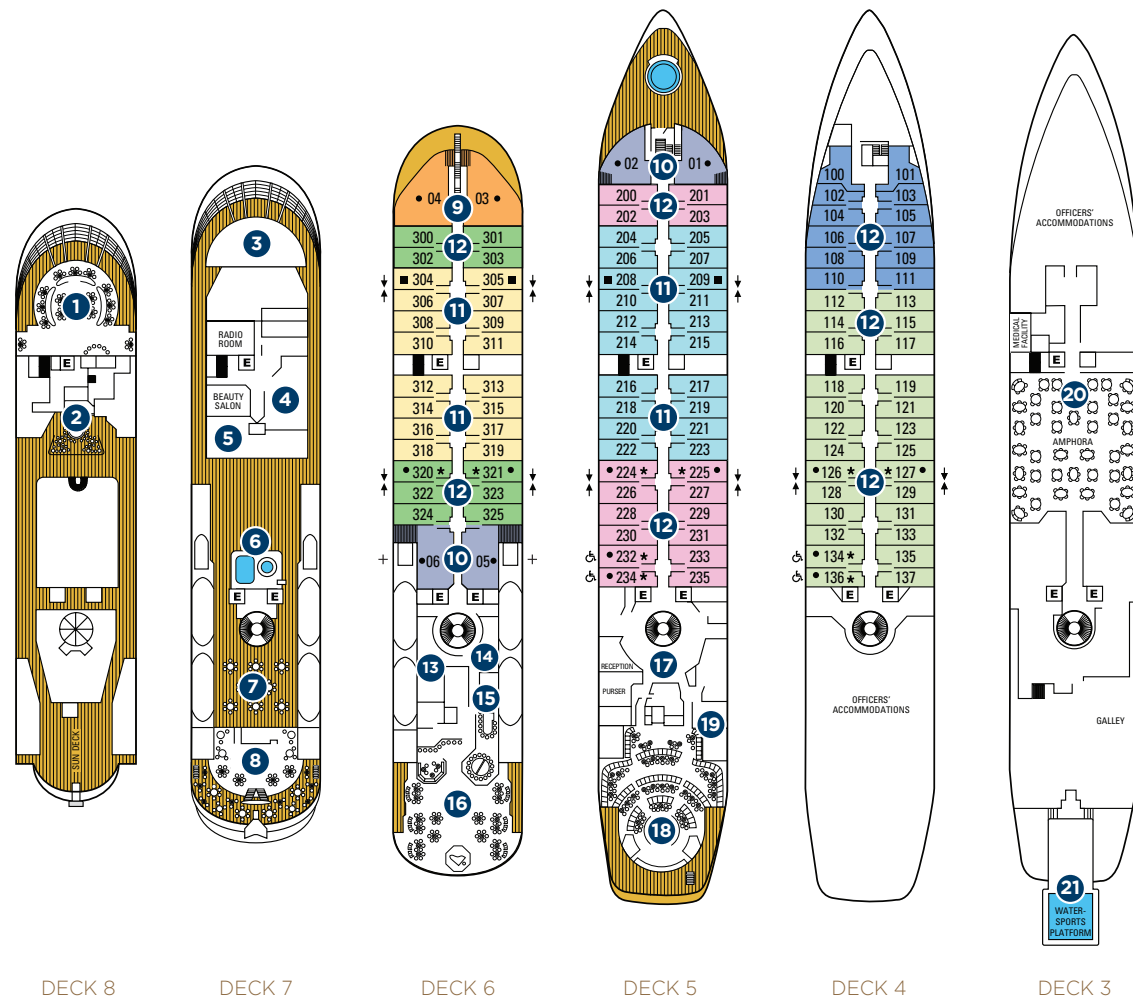

ONBOARD SPACES

- |  |                      |   |
|--|----------------------|---|
| 1 Yacht Club   | 8 Veranda/Candles    | 17 Reception  |
| 2 Star Bar   | 9 Owner's Suites     | 18 Lounge   |
| 3 Bridge   | 10 Classic Suites    | 19 Screening Room (Computer Center on <i>Star Pride</i> ) |
| 4 WindSpa  | 11 Balcony Suites    | 20 AmphorA Restaurant                                     |
| 5 Fitness Center   | 12 Ocean View Suites | 21 Watersports Platform                                   |
| 6 Counter-current pool and whirlpool (Whirlpools only on <i>Star Pride</i> ) | 13 Signature Shop    |   |
| 7 Courtyard (Pool on <i>Star Pride</i> )                                     | 14 Library           |   |
|  | 15 Casino            |   |
|  | 16 Compass Rose      |   |

- + RESTRICTED VIEW
- ↓ ADJOINING SUITES
- E ELEVATOR
- ONE QUEEN SIZE BED ONLY (no twin option)
- \* SHOWER ONLY
- SHOWER ONLY (*STAR LEGEND*)
- ♿ MODIFIED ACCESSIBLE SUITES  
Feature a full-size bed (no twin option)  
Suites 134, 136, 232 & 234, are modified accessible, shower only with a small lip into shower, a step into the bathroom with a portable ramp, standard interior and exterior doorways.

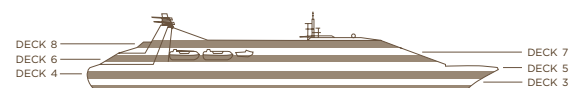

- OWNER'S SUITE (OW)
- CLASSIC SUITE (CS)
- BALCONY SUITE 1 (BS1)
- BALCONY SUITE (BS)
- OCEAN VIEW SUITE 3 (S3)
- OCEAN VIEW SUITE 2 (S2)
- OCEAN VIEW SUITE 1 (S1)
- OCEAN VIEW SUITE (S)

- Access to board ship is via stairs only.
- Access to/from outside deck may require assistance with doors and thresholds.



ALL SUITE YACHTS

- Owner's Suites (OW):**  
575 square feet (54 square meters)
- Classic Suites (CS):**  
Forward Suites, 01 and 02 — 400 square feet (37 square meters)  
Midship Suites, 05 and 06 — 530 square feet (49 square meters)
- Suites with 3rd berths — 05 and 06 on *Star Breeze* and *Star Legend* only

- Balcony Suites (BS, BS1):**  
277 square feet (26 square meters)
- Suites with 3rd berths — 204-205, 222-223 on *Star Breeze* and *Star Legend* only
- Ocean View Suites (S, S1, S2, S3):**  
277 square feet (26 square meters)
- Suites with 3rd berths — 112-115, 300-301 on *Star Breeze* and *Star Legend*

- Modified Accessible Suites:**  
277 square feet (26 square meters), (Suites 134, 136, 232, 234).



Owner's Suite, Forward



Classic Suite, Midship

SHIP FACTS

- GUEST CAPACITY:** 212
- GUEST DECKS:** 6
- CREW MEMBERS:** 145
- LENGTH:** 440 feet (134 meters)
- BEAM:** 63 feet (19 meters)
- DRAFT:** 16.5 feet (5 meters)
- CRUISING SPEED:** 15 knots
- PROPULSION:** Twin propeller, driven by four Bergen marine diesel engines
- TONNAGE:** 9,975 grt (gross registered tons)
- SHIP'S REGISTRY:** Bahamas



Classic Suite, Forward

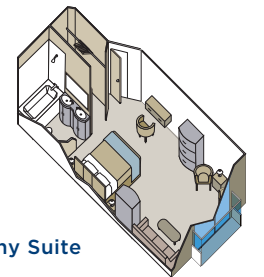

Balcony Suite

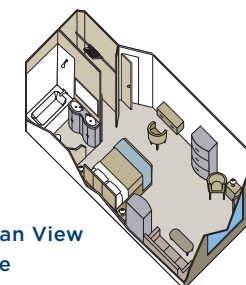

Ocean View Suite

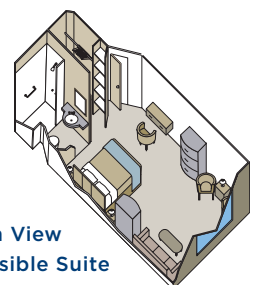

Ocean View Accessible Suite